

VELUX INTEGRA® Solar GGU Low Energy

ENGLISH: Directions for use

VELUX®

Opening and closing the window

Operate the window with control pad KLR 200.



Cleaning the pane

Cleaning the outer pane: Open the window fully with the control pad. Remove the cover plate and screws. Rotate the sash 180 degrees. The sash must be secured in position by sliding the barrel bolt into the bushing at the bottom of the side frame. This safety feature leaves both hands free for cleaning.

Cleaning between the panes: Loosen the screws in both bottom corners and swing the secondary pane open.

Clean the panes with a soft, clean, lint-free cloth/chamois leather/non-abrasive sponge or a clean, non-metal window squeegee. Clean water will normally be sufficient for cleaning the pane. Ordinary, non-abrasive household cleaners can also be used.

Warning

- Avoid contact from silicone with the panes.
- Do not use any cleaning products containing abrasive particles.
- Do not use household cleaners containing high levels of acid or alkaline for cleaning the panes.
- Avoid contact with the panes from all sharp or abrasive objects including jewellery.
- Never attempt to clean off dirt on the panes without first applying water.
- If any works are taking place in the vicinity of the panes, protect the panes with a clean plastic sheet to prevent any splashes or staining from aggressive and abrasive compounds.

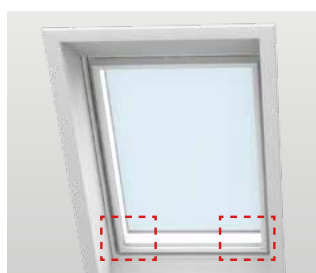
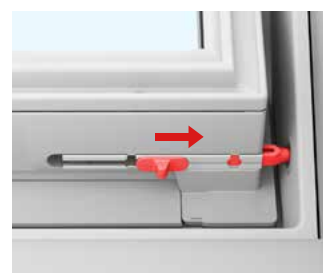
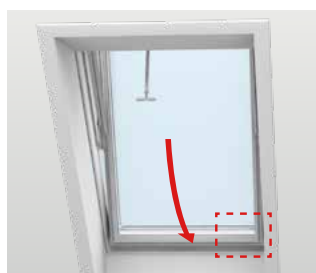
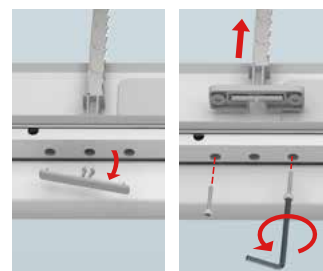
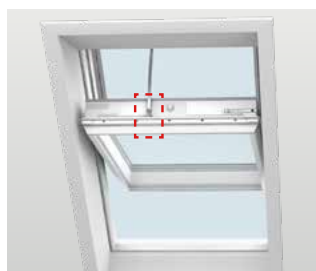

ThermoTechnology™

VELUX INTEGRA® Solar GGU Low Energy

ENGLISH: Directions for use

VELUX®

Minimising condensation

Particularly in rooms with high levels of humidity, condensation can form on the inner panes of the window. This can be minimised by fitting a radiator directly below the window and by airing the room frequently.

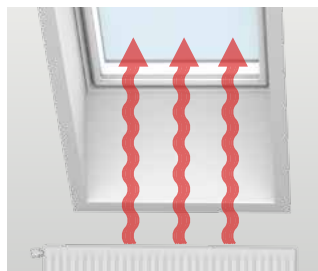

Cleaning the window

The white polyurethane surface can be cleaned with ordinary household cleaners.



Cleaning the flashing

Leaves and other debris should be removed from the flashing around the window to allow rainwater to flow freely.



Snow and ice

It is important to make sure that water can always drain off from the window and surrounding gutters. Snow and ice should therefore be removed from the area on and around the window in the same way as leaves and other debris should be removed from flashing and gutters to allow melt water to flow freely.

