

ETS+EDS

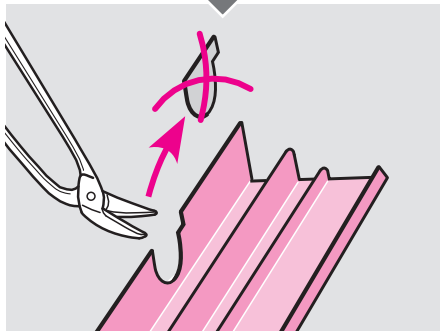

INSTALLATION INSTRUCTIONS FOR ETS+EDS. ©2008 VELUX GROUP. VELUX AND THE VELUX LOGO ARE REGISTERED TRADEMARKS USED UNDER LICENCE BY THE VELUX GROUP.

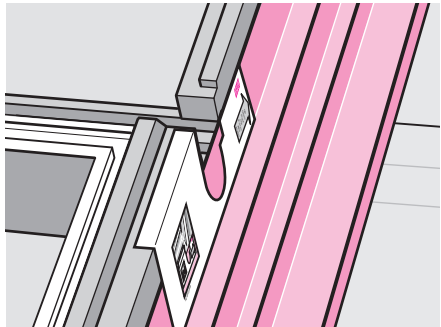
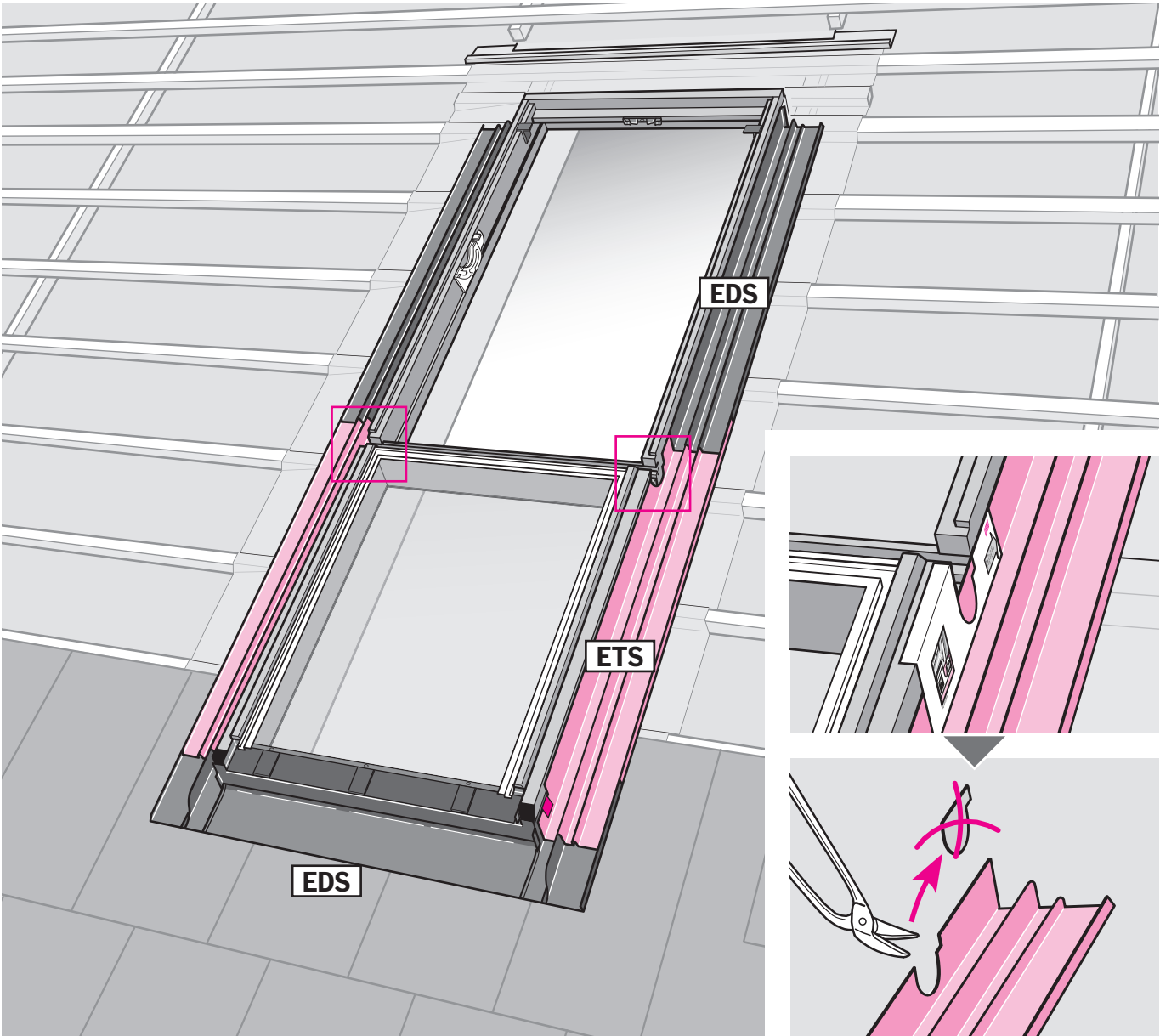
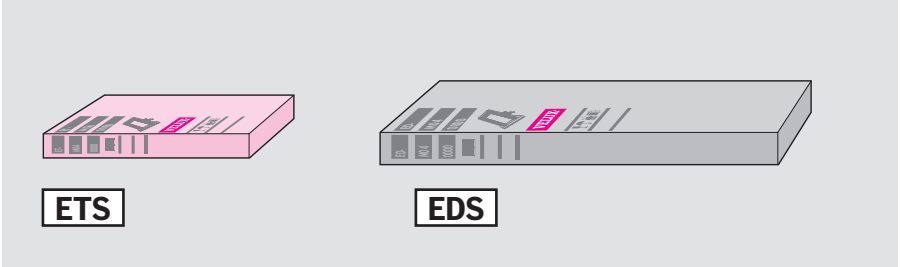

ETS/ETX+EKS

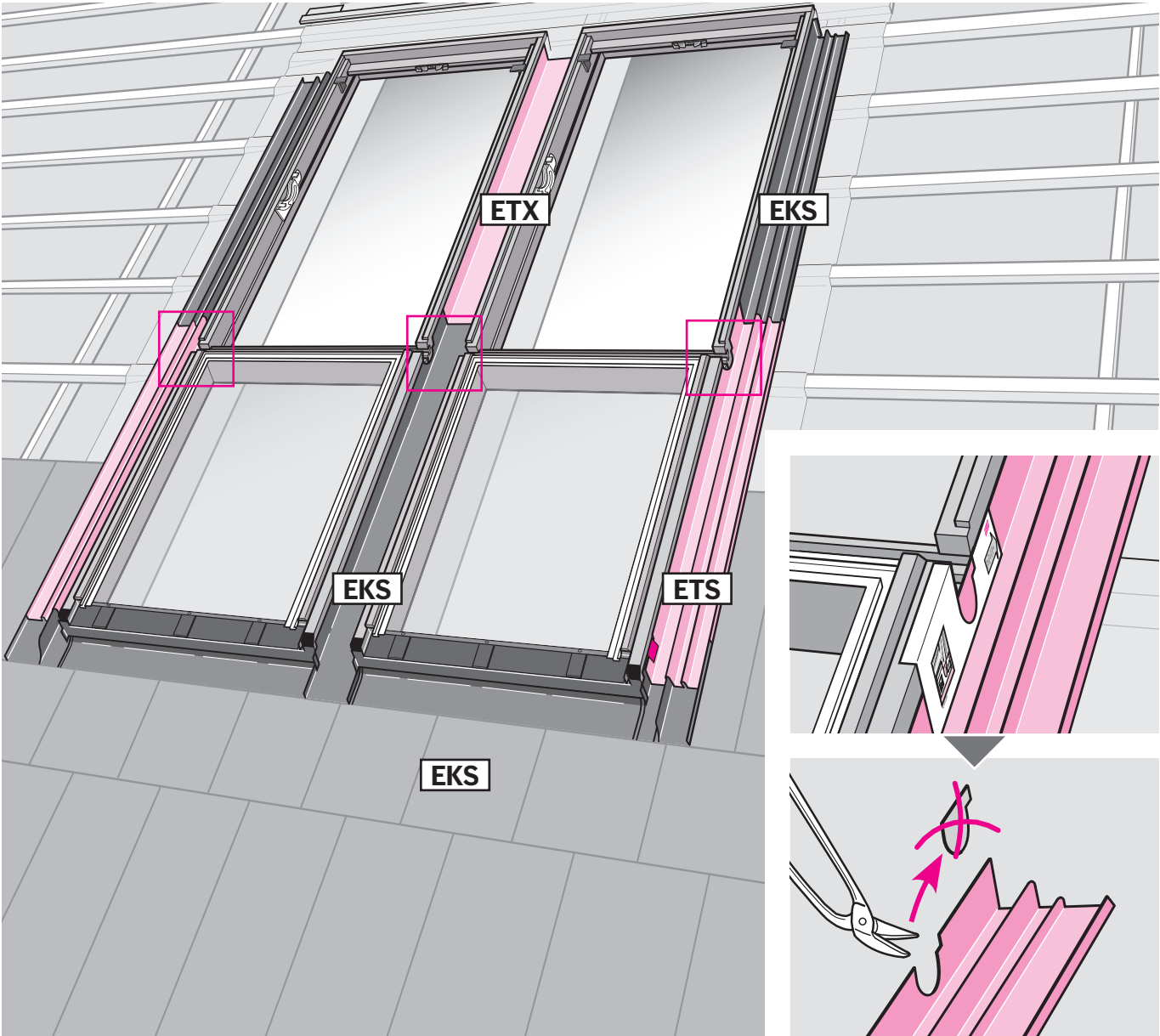
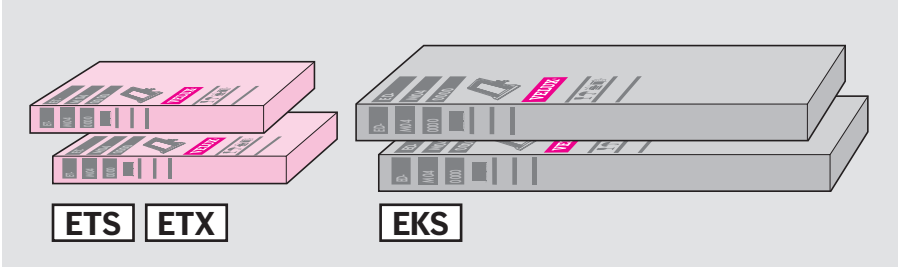
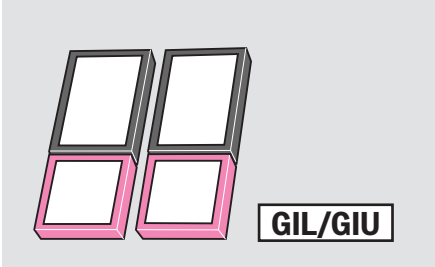

INSTALLATION INSTRUCTIONS FOR ETS/ETX+EKS. ©2008 VELUX GROUP. VELUX AND THE VELUX LOGO ARE REGISTERED TRADEMARKS USED UNDER LICENSE BY THE VELUX GROUP.

