

<b>English</b>	Setup of KLI 311 to operate VELUX INTEGRA® sloped roof window GGL/GGU or VELUX INTEGRA® solar upgrade kit KSX 100/100K	2
<b>Deutsch</b>	Coming soon	
<b>Français</b>	Coming soon	
<b>Dansk</b>	Coming soon	
<b>Nederlands</b>	Coming soon	
<b>Italiano</b>	Coming soon	
<b>Español</b>	Coming soon	
<b>Bosanski</b>	Coming soon	
<b>Български</b>	Coming soon	
<b>Česky</b>	Coming soon	
<b>Eesti</b>	Coming soon	
<b>Hrvatski</b>	Coming soon	
<b>Latviski</b>	Coming soon	
<b>Lietuvių</b>	Coming soon	
<b>Magyar</b>	Coming soon	
<b>Norsk</b>	Coming soon	
<b>Polski</b>	Coming soon	
<b>Português</b>	Coming soon	
<b>Română</b>	Coming soon	
<b>Русский</b>	Coming soon	
<b>Slovenščina</b>	Coming soon	
<b>Slovensky</b>	Coming soon	
<b>Srpski</b>	Coming soon	
<b>Suomi</b>	Coming soon	
<b>Svenska</b>	Coming soon	
<b>Türkçe</b>	Coming soon	
<b>Українська</b>	Coming soon	

If a non-functional wall switch must be replaced or if the wall switch cannot find certain products, the products can be prepared for registration by resetting them manually.

**Note:** Reset products cannot be operated until they have been registered in the wall switch again.

**Important:** This only applies to KLI 311.

- 1 Turn the power on. Open window manually (if the window is open, you must close it by pressing the test button on the window operator).

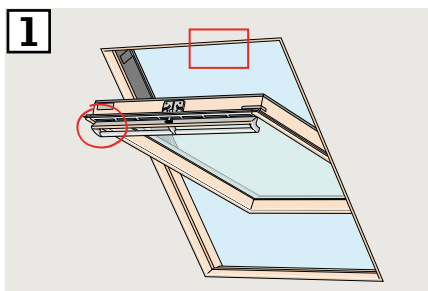

- 2 There are two ways of resetting depending on window type. The ventilation flap can look like 2A or 2B.

Press the test button on the window operator for at least 10 seconds. The window operator will run briefly back and forth.

**Note:** Registration (3) and (4) must now be completed within the next 10 minutes.

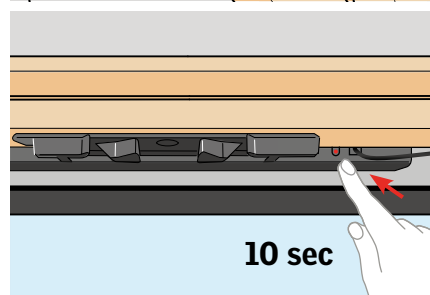
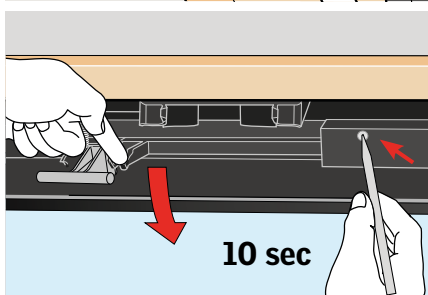
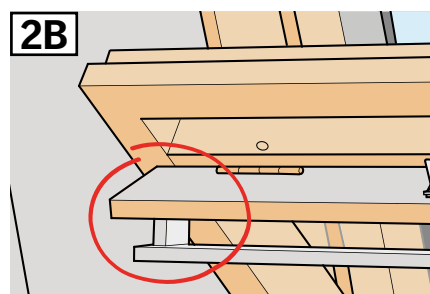
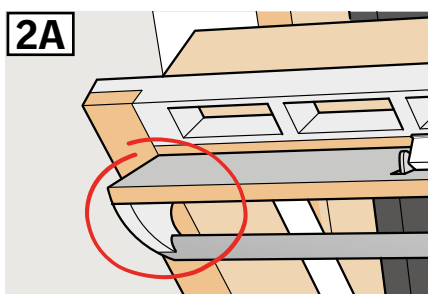

- 3 Press PAIR button on the wall switch for 1 second.

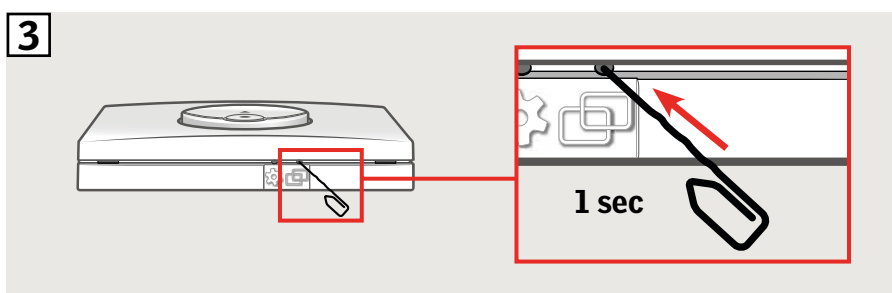

- 4 Close the window manually.  
5 The window can now be operated with the wall switch.

